

### BOUNDARY MAP OF PROPOSED COMMUNITY FACILITIES DISTRICT NO. 07M

CITY OF CHULA VISTA  
COUNTY OF SAN DIEGO  
STATE OF CALIFORNIA

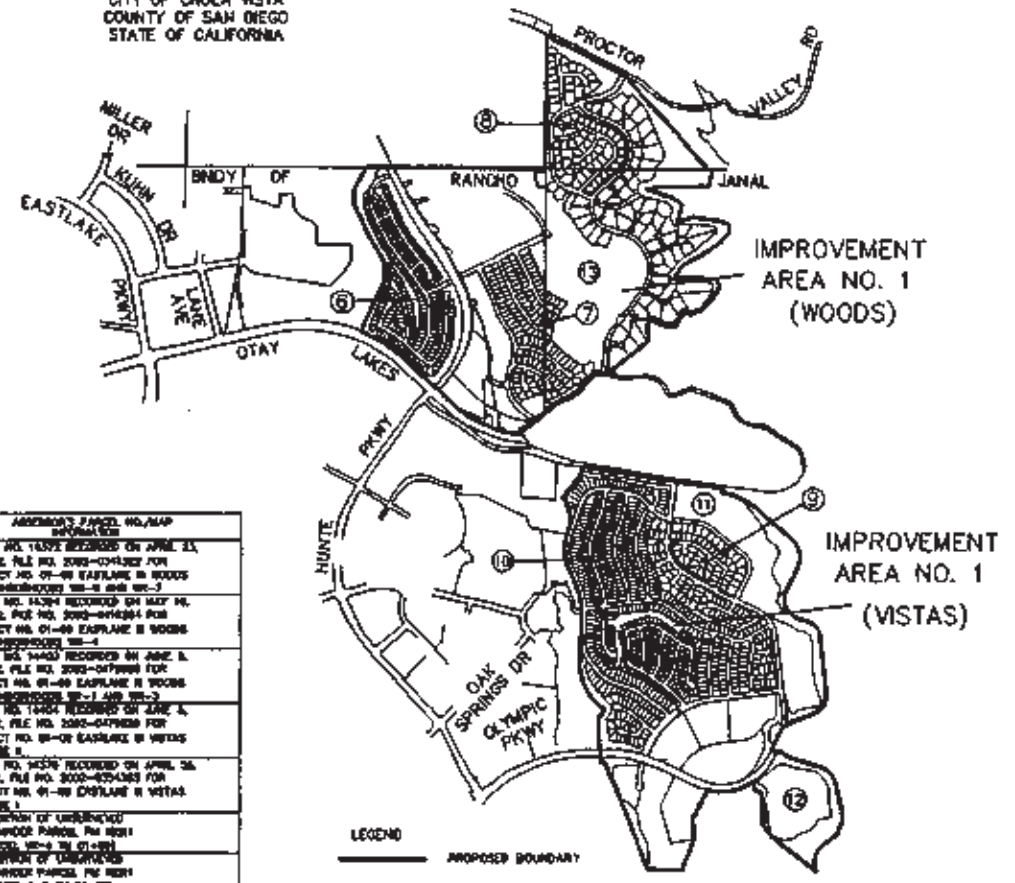

MAP REF. NO.	ADDRESSOR'S PARCEL NO./MAP INFORMATION
6	MAP NO. 14392 RECORDED ON APRIL 23, 2002, FILE NO. 2002-024182 FOR TRACT NO. 01-00 EASTLAKE IN WOODS (REMANDED PARCEL PG 1081)
7	MAP NO. 14394 RECORDED ON MAY 16, 2002, FILE NO. 2002-014284 FOR TRACT NO. 01-00 EASTLAKE IN WOODS (REMANDED PARCEL PG 1081)
8	MAP NO. 14393 RECORDED ON JUNE 3, 2002, FILE NO. 2002-017899 FOR TRACT NO. 01-00 EASTLAKE IN WOODS (REMANDED PARCEL PG 1081)
9	MAP NO. 14394 RECORDED ON JUNE 3, 2002, FILE NO. 2002-017899 FOR TRACT NO. 01-00 EASTLAKE IN WOODS (REMANDED PARCEL PG 1081)
10	MAP NO. 14376 RECORDED ON APRIL 26, 2002, FILE NO. 2002-023485 FOR TRACT NO. 01-00 EASTLAKE IN VISTAS (REMANDED PARCEL PG 1081)
11	A PORTION OF UNRECORDED REMANDED PARCEL PG 1081 (TRACTS 01-00 TO 01-03)
12	A PORTION OF UNRECORDED REMANDED PARCEL PG 1081 (TRACTS 01-04 TO 01-07)
13	A PORTION OF UNRECORDED REMANDED PARCEL PG 1077 (TRACTS 01-08 TO 01-09)

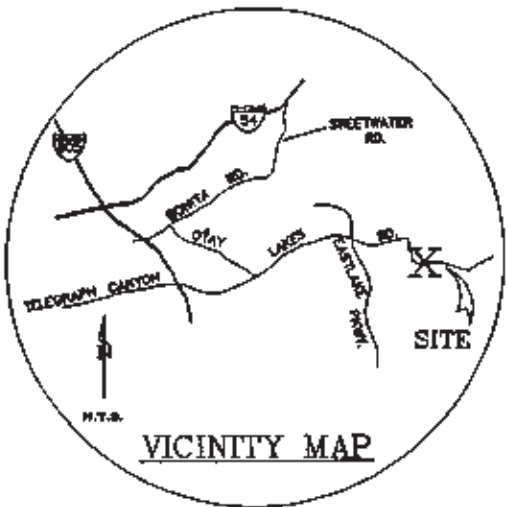
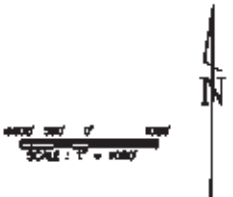

**MuniFinancial**  
22705 Single Oak Drive  
Suite 200  
Torrance, California 90509-8804  
Phone (310) 906-2886 Fax (310) 940-5480

**LEGEND**

— PROPOSED BOUNDARY

⑥ MAP REFERENCE NUMBER

700021-010-19 (01-07) JUN 2002

**BK36 P632**

**2002-0603796**



MuniFinancial  
 Page A-2  
 City of Chula Vista  
 Community Facilities District No. 07M (Revised)